

# Specification

## Double color fog surface casing series

### NTS1220





### Features:

- **Light source:** High luminous efficiency, SMD2835、2735、5050LED, LM80 proved.
- **Process & Material:** High light transmittance, environmental silicone material, integrated extrusion molding technology, IP65.
- **Optical Design:** Unique optical light distribution structure design, uniform lighting surface and no shadow.
- **Appearance Design:** Compared with the traditional neon tube or PVC guardrail tube, the silicone material has good flexibility, the simple and stylish appearance, which is exquisite and unique.
- **Product Certification:** UL、CE、ROHS.
- **Environmental Features:** Resistance to saline solutions, acids & alkali, corrosive gases and UV.
- **Working/Storage Temperature:** Ta:-20~45°C / 0°C ~ 60°C.
- **Life Span:** 36000H, 2~3 years warranty (White Light, Colored Light, RGB 3 years warranty; Magic color 2 years warranty).

### Structure Parameters:

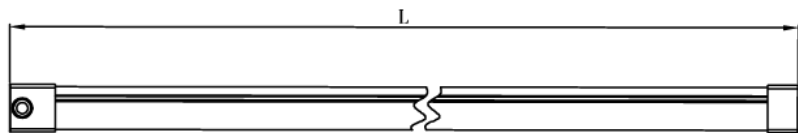
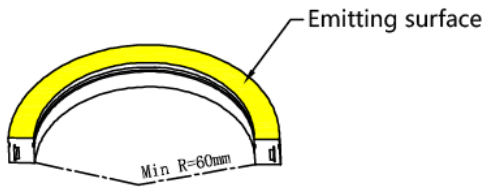

Note: L=5000mm

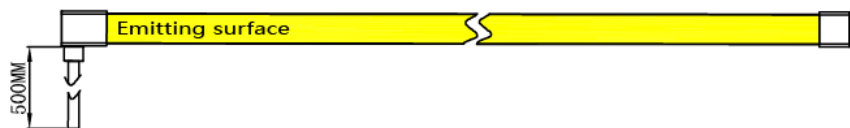
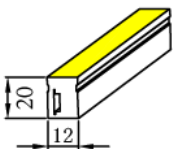

## Basic Parameters:

Model	CCT/Colors	CRI	Input voltage (V)	Rated current (A)	Rated power (w)	Lumens (LM)	Size (mm)	Max.length	Cutting unit (mm)	Beam angle	IP
NTS1220-8XX24CSN050CCXXXX	2300K	>80	24	0.4	9.6	220	W12*H20	5000mm	50	115°	IP65
	2700K					220					
	3000K					230					
	4000K					190					
NTS1220-8SWW24CSN050CCXXXX	2300~4000K	>80	24V	0.6	14.4	330			100		
NTS1220-0X24CSN050CC0500	R 620-630nm	/	24V	0.34	8	/					
	G 525-530nm					/					
	B 465-470nm					/					
	Y 587-592nm					/					
NTS1220-0RGB24CSN050CC0500	RGB R 620-630nm G 525-530nm B 465-470nm	/	24V	0.5	12	/			83		
NTS1220-0RGBX05CSN050CC0250	RGBX R 620-630nm G 525-530nm B 465-470nm	/	5V	2.8	14.4	/	2500mm	16.6			
NTS1220-0RGBX12CSN050CC0500	RGBX R 620-630nm G 525-530nm B 465-470nm	/	12V	1.2	14.4	/	5000mm	50			

Note:

1. The above data is the testing result of 1M standard product;
2. The power and lumens of output data can be vary up to  $\pm 10\%$ ;
3. The above parameters are all typical values

## Light Distribution:

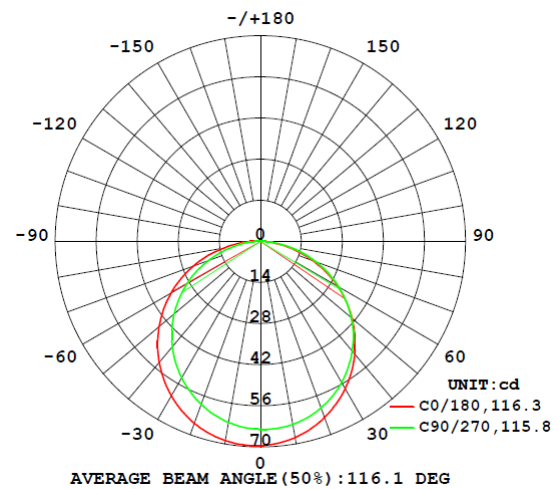
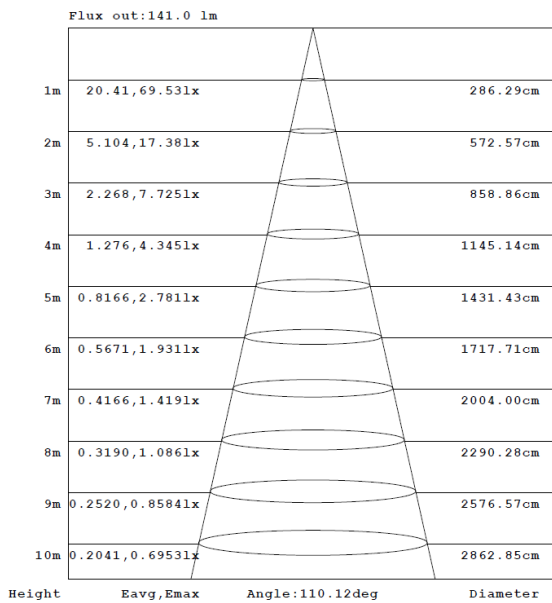

White Light Neon Strip



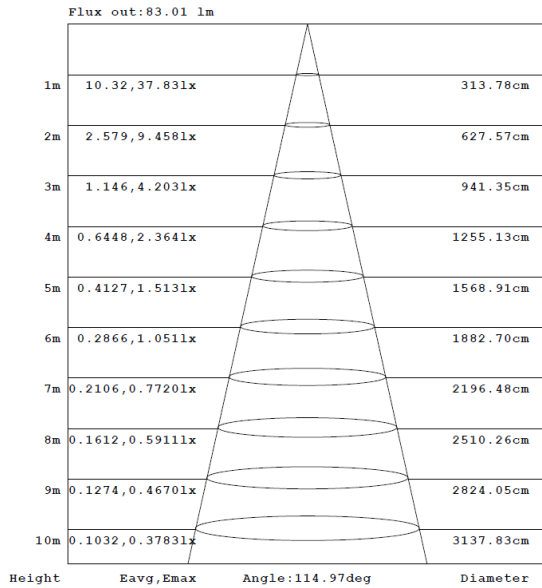

AAI Figure

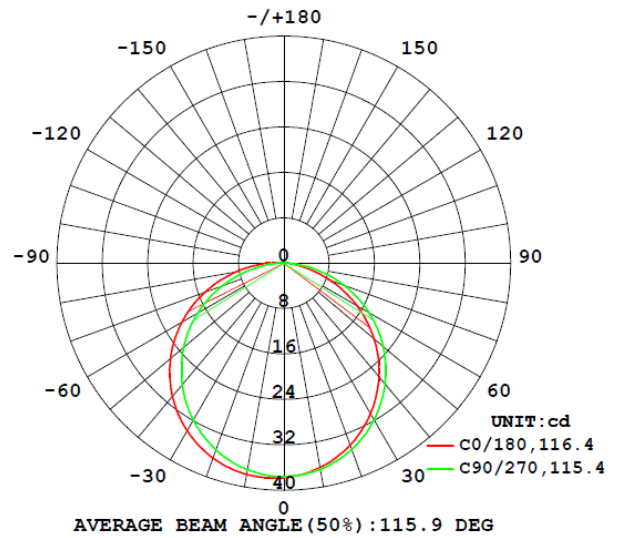

RGB Neon Strip

Photometric of 1M strip

## Accessory information:

Name	Description	Image	Ordering code	Product quantity/case	Product net weight (kg)	Net weight per box (kg)	Gross weight (kg)	Package size (mm)	Remark
Aluminium carrier	Flat mounting aluminum groove		AS-NTS1220A-1000	12 PCS	0.11	1.43	2.48	1290*112*50	Size : L1000*W14.1*H20mm attached screw
Aluminum clip	Flat mounting of clip		AS-NTS1220A-25	350 PCS	0.003	1.05	1.35	250*250*150	Size : L25*W14.1*H20mm attached screw
End cap set	Silica end cap set, with end cap and plug		AS-NTS1220GS0-EC	400 PCS	0.0034	1.36	1.66	250*250*150	Plug Size: L23*W18*H21mm End cap Size: L23*W15*H12mm
Gum filler	588ST acid gel		AS-PG-0001	150 PCS	0.014	2.1	2.4	250*250*150	10ml/pcs
Wire	2P PVC wire (0.5M)		AS-WS-0001	150 PCS	0.01541	2.31	2.61	250*250*150	Suitable for white light neon strip
Wire	2P PVC wire (2M)		AS-WS-0002	125 PCS	0.0616	7.7	8		
Wire	4P PVC wire (0.5M)		AS-WS-0003	150 PCS	0.0194	2.91	3.21	250*250*150	Suitable for RGB neon strip
Wire	4P PVC wire (2M)		AS-WS-0004	125 PCS	0.0776	9.7	10		
Connectors	2PIN IP68 Waterproof Connectors		AS-FC-0001	512 PCS	0.016	8.192	9.5	365*365*190	Suitable for white light neon strip
Connectors	3PIN IP68 Waterproof Connectors		AS-FC-0002	512 PCS	0.018	9.216	10.2	365*365*190	/
Connectors	4PIN IP68 Waterproof Connectors		AS-FC-0003	512 PCS	0.03	8.64	9.6	365*365*190	Suitable for RGB neon strip



## Wiring Diagram:

### Non-dimming connection mode:

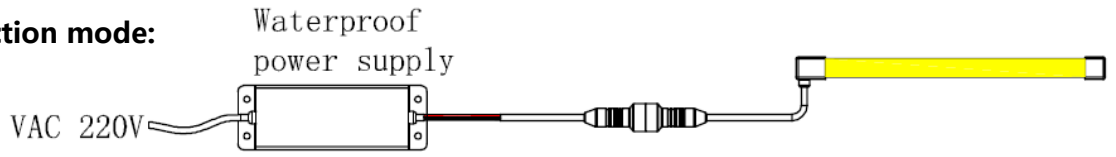

### Dimming connection mode:

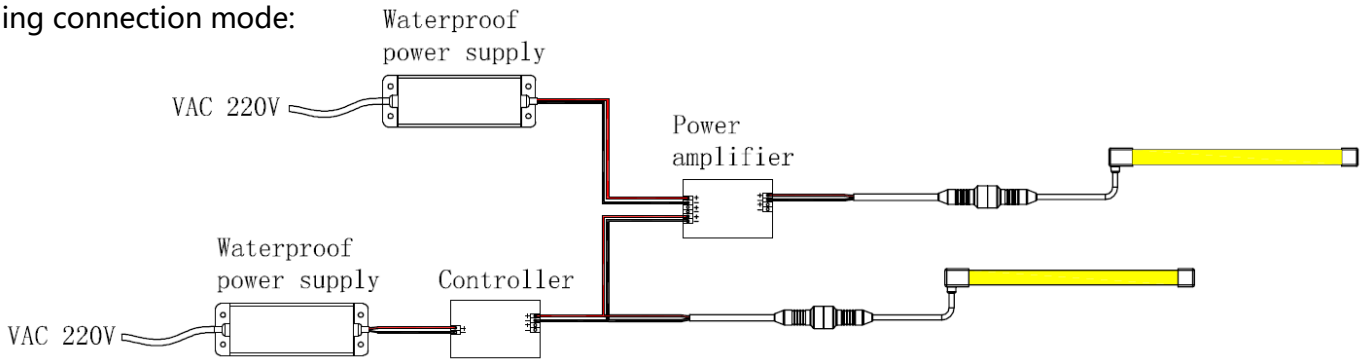

### Magic color connection mode:

## 5. Wiring Diagram:

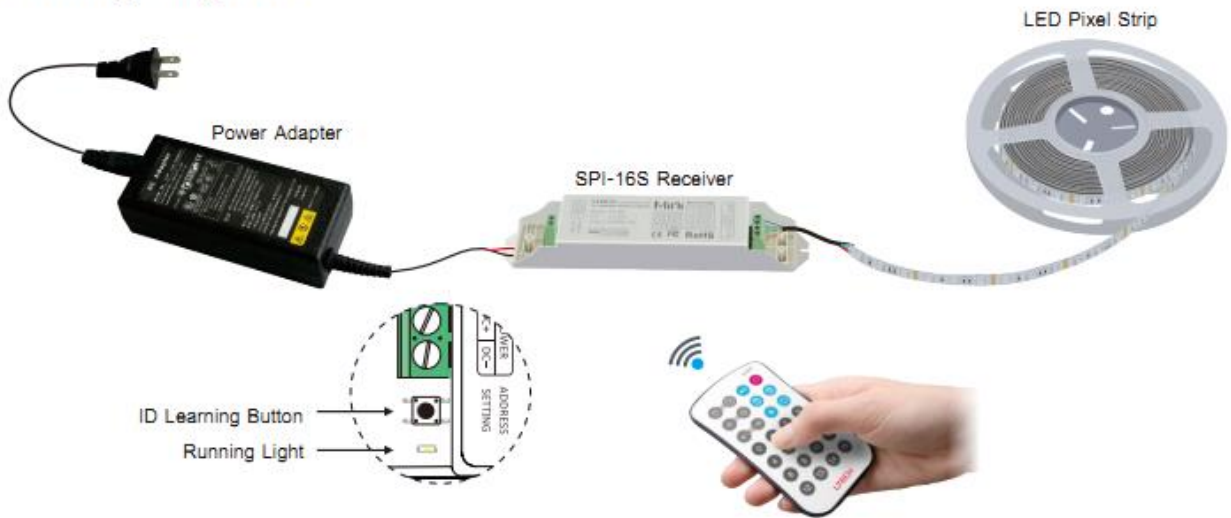

### LED pixel strip wiring diagram:

#### a. Conventional connection method.

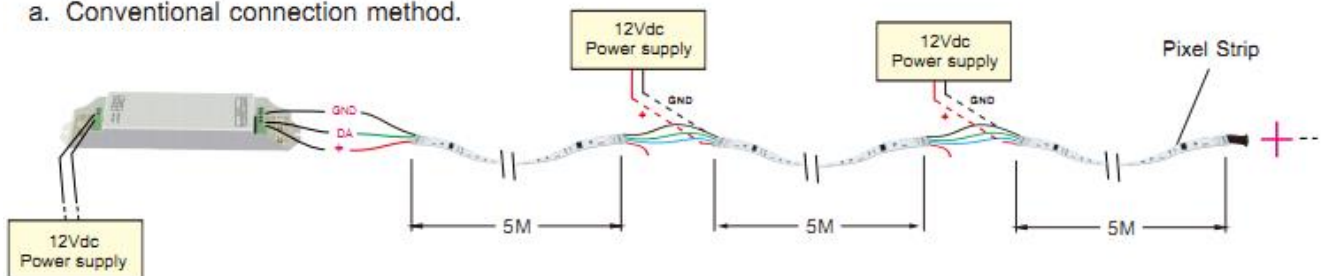

# Installation Guidance:

## Installation of clip

1. Use screws to fix the clips or carriers on the mounting position

⚠ Clip: 3 clips can be used for 1m;

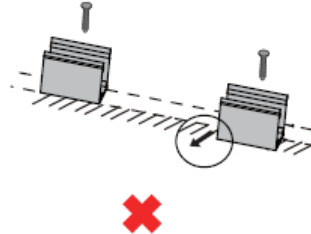
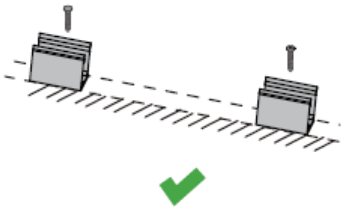

## Installation of carrier

1. When installing the LED strip, install it from both ends at the same time, installation from one direction is prohibited.

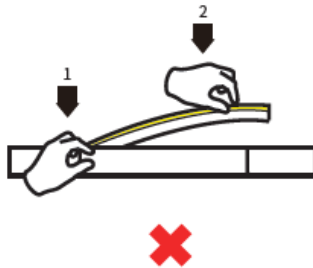
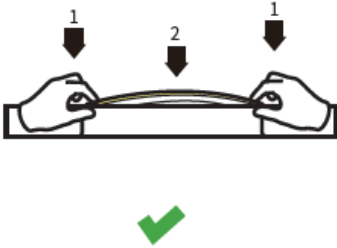

⚠ If the length of LED strip is over 2m, it is recommended to install by two persons.



2. Use tool to disassemble carefully, and do not pull the LED strip directly.

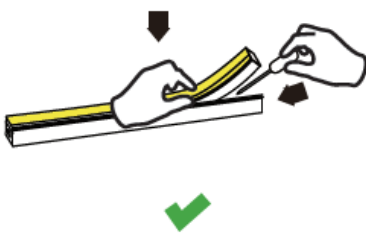

⚠ If the length of LED strip is over 2m, it is recommended to disassemble by two persons.

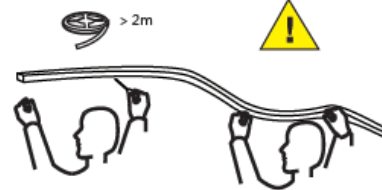

## Packaging Solutions:



PN:NTS1220  
Color:2700K  
DC24V

PN:NTS1220  
Color:2700K  
DC24V

**NTS1220**

Power(Typ): 10.6W/m	Type: Silicon neon strip
Power(Max): 9.6W/m	Part NO: NTS1220-8XXCSN050CC0500
Color/CCT: 2700K	SO: 17040116
IP: IP67	Size: 5000x12x20mm
	Voltage: DC24V

[www.colorsled.com](http://www.colorsled.com) 2700K

---

QTY: PCS  
N.W: KGS  
G.W: KGS  
QC Date: No.:

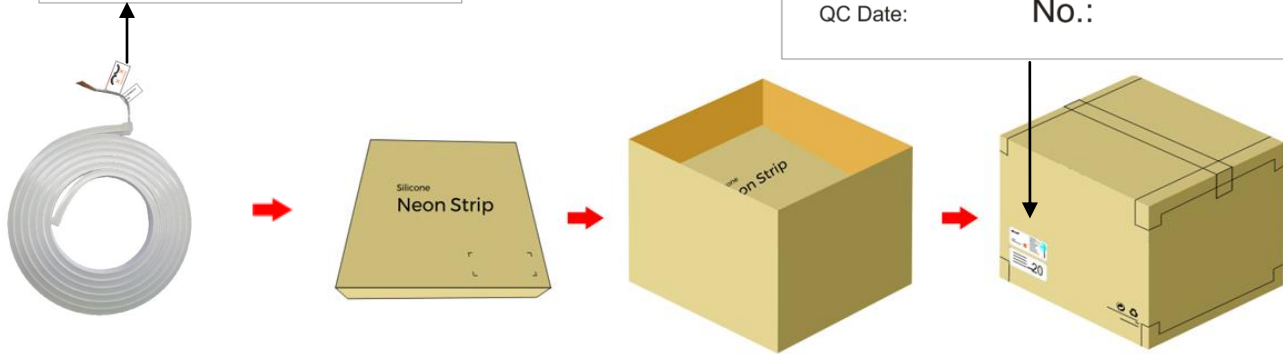

Name	Bending direction	Product size	Product Quantity/box	Product Quantity/case	Product net weight (kg)	Net weight per box (kg)	Gross weight (kg)	Carton size
NTS1220-XXX24CSN050CC0500	Side view	L5000*12*20mm	5M*2	40M	1.3	11.4	12.88	0.41*0.41*0.2
NTS1220-0RGBXXCSN050CC0500		L5000*12*20mm	5M*2	40M	1.3	11.4	12.88	6M

## Ordering Code:

Category	Series	Bending direction	Section size		CRI	CCT	Voltage		Silk printing	Entry cable	Wire type	Wire length		Brand code	Label type		LED strip length													
			1	2			24	24V				5	05V		12	12V	C	COLO	S	On end	PNC	050	500	C	COLO	C	COLOR	0500	5M	
N	Silicone Neon Strip	Double color fog surface casing series	S	Side view	1	2	0	0	8	0	LW2300K SW2700K WW3000K NW4000K	24	24V	5	05V	12	12V	C	COLO	S	On end	PNC	050	500	C	COLO	C	COLOR	0500	5M
																		S	Cust				200	200			S	Cust	0250	5M
																		N	Neutra											

Ordering example : NTS1220-8LW24CSN050CC0500



## Precautions:

- Use a 24V DC isolated power supply to drive the neon lamp strip and the ripple wave of constant voltage source shall be less than 5%. It is not allowed to use RC voltage reduction or non-isolated power supply to drive the neon lamp strip.
- In actual applications, 20% of the power supply shall be kept (only 80% of the power is used) to guarantee that sufficient voltage is available to drive the product.
- Attention shall be paid to safe operation. After powering on, it is not allowed to touch the AC power supply to avoid an electric shock.
- Attention shall be paid to the positive and negative poles of the wires during installation and whether the power supply conforms to required voltages to avoid damages.
- Avoid scratching, distortion and irregular bending of the product during installation; otherwise it may cause irreparable damage to the product.
- Please do not bend the strip into an arc with a radius less than 60mm to ensure the longevity and reliability, the bending radius too small will damage the product itself.
- If the actual length of application exceeds the specified using length, it will lead to overload heating and uneven brightness.
- To keep the eyes from being harmed, try to avoid staring at the glowing side of the LED strip for a long time.
- Non-professionals are prohibited from installing, disassembling and repairing the product.
- Do not use any acid or alkaline adhesive to fix products (including not limited to glass cement, etc.)
- Product is not suitable for use in swimming pools and fountains.

